

JARRELL INDEPENDENT SCHOOL DISTRICT |

Middle School Addition and Renovations

December 15, 2021

SCHEMATIC DESIGN PRESENTATION



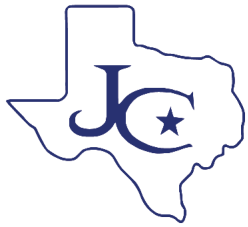

JARRELL INDEPENDENT SCHOOL DISTRICT
MIDDLE SCHOOL ADDITIONS & RENOVATIONS

ACKNOWLEDGMENTS 01

PROGRAM 02

SITE PLANS 03

FLOOR PLANS AND RENDERING 04

OPINION OF PROBABLE COST 05

SCHEDULE 06



JARRELL INDEPENDENT SCHOOL DISTRICT
MIDDLE SCHOOL ADDITIONS & RENOVATIONS

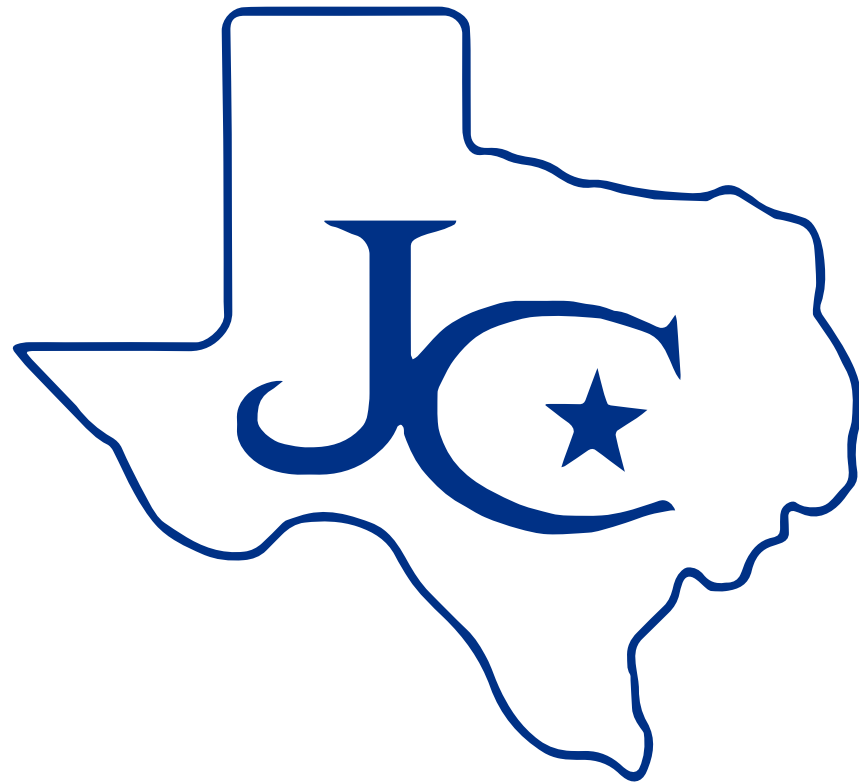

DISTRICT BOARD OF TRUSTEES

Crystal Phalen	Board President
Jenny Arnold	Board Vice President
Tamara Dozier	Board Secretary
Troy Clawson	Board Member
Kenneth Leverett	Board Member
Bruce Epstein	Board Member
Rebecca Kirby	Board Member

BUILDING COMMITTEE AND CONTRIBUTING STAFF

Dr. Toni Hicks	Superintendent
James Larremore	Director of Operations
Pennee Hall	Executive Director, HR
Kelly Blair	Daren Childs
Stephen Grant	Fawn Keith
Brad Louder	Bobby Sugg
Cheryl Collie	

PROGRAM MANAGEMENT

ESC Region 13
Sledge Engineering, LLC

PROJECT TEAM

LaShae Baskin, RID
Director of Austin, Huckabee

Michael Morow, AIA
Principal, Huckabee

Mike Hall, AIA
Director of Design, Huckabee

Mike Vermeeren, AIA
Director of Planning, Huckabee

Tina Alford, AIA
Project Architect, Huckabee

Jesus Rodriguez,
Architectural Associate, Huckabee

Anna Abascal,
Interior Designer, Huckabee

**CIVIL ENGINEERING &
LANDSCAPE ARCHITECTURE**

Langan
Austin, TX

STRUCTURAL ENGINEERING

RSCR Engineers
San Antonio, TX

MEP ENGINEERING

Hendrix Consulting Engineers
Round Rock, TX

TECHNOLOGY

CRUX
Fort Worth, TX



JARRELL INDEPENDENT SCHOOL DISTRICT MIDDLE SCHOOL ADDITIONS & RENOVATIONS

Jarrell ISD					
2021 Bond: Middle School Renovation/ Addition	Requested Program				
Additional 240-student capacity	# of spaces	Capacity Per Space	Net Capacity	Area per space (S.F.)	Net Area (S.F.)
INSTRUCTIONAL SPACES					14,950
Additions					14,950
Instructional Spaces					14,000
General Classroom	11	25	275	800	8,800
Specialized Instruction/ Lab	1	25	25	1,600	1,600
Flex Classroom	2	0	0	800	1,600
Small Group Breakout	2	0	0	150	300
Resource	1	0	0	550	550
Teacher Planning	2	0	0	575	1,150
Instructional Support					200
Storage Room	2			100	200
Restrooms					750
Student Toilets	2			350	700
Teacher Toilet	1			50	50
CORE SPACES					2,575
Library					450
Book Storage (relocate existing)	1			450	450
Cafeteria					2,125
Additional dining space	1			1,800	1,800
Additional serving space	1			325	325
PHYSICAL EDUCATION					1,800
Locker Rooms					1,800
Girls Athletics	1			1,800	1,800
Boys PE	1			1,100	1,100
Girls PE	1			1,100	1,100

MAIN ADMINISTRATION					1,325
Administrative Spaces					1,325
Registrar Office	1			130	130
Counselor Office	1			130	130
Expanded Clinic (Isolation Room)	1			80	80
Principal Office	1			175	175
AP Office	2			150	300
Instr. Coach Office	1			130	130
Conference Room	1			380	380
BUILDING SUPPORT SPACES					425
Custodial					100
Custodial Closet	1			100	100
MEP					200
Electrical	1			150	150
Mechanical Mezzanine Access	1			50	50
Technology					125
IDF	1			125	125

Capacity Totals	300	80% (utilization) = Capacity of	240	
SUBTOTAL NET AREA (s.f.)				21,075
Additional Common Area (walls, circulation)				8,009
Circulation Factor				38%
TOTAL GROSS AREA (s.f.)				29,084



JARRELL INDEPENDENT SCHOOL DISTRICT MIDDLE SCHOOL ADDITIONS & RENOVATIONS

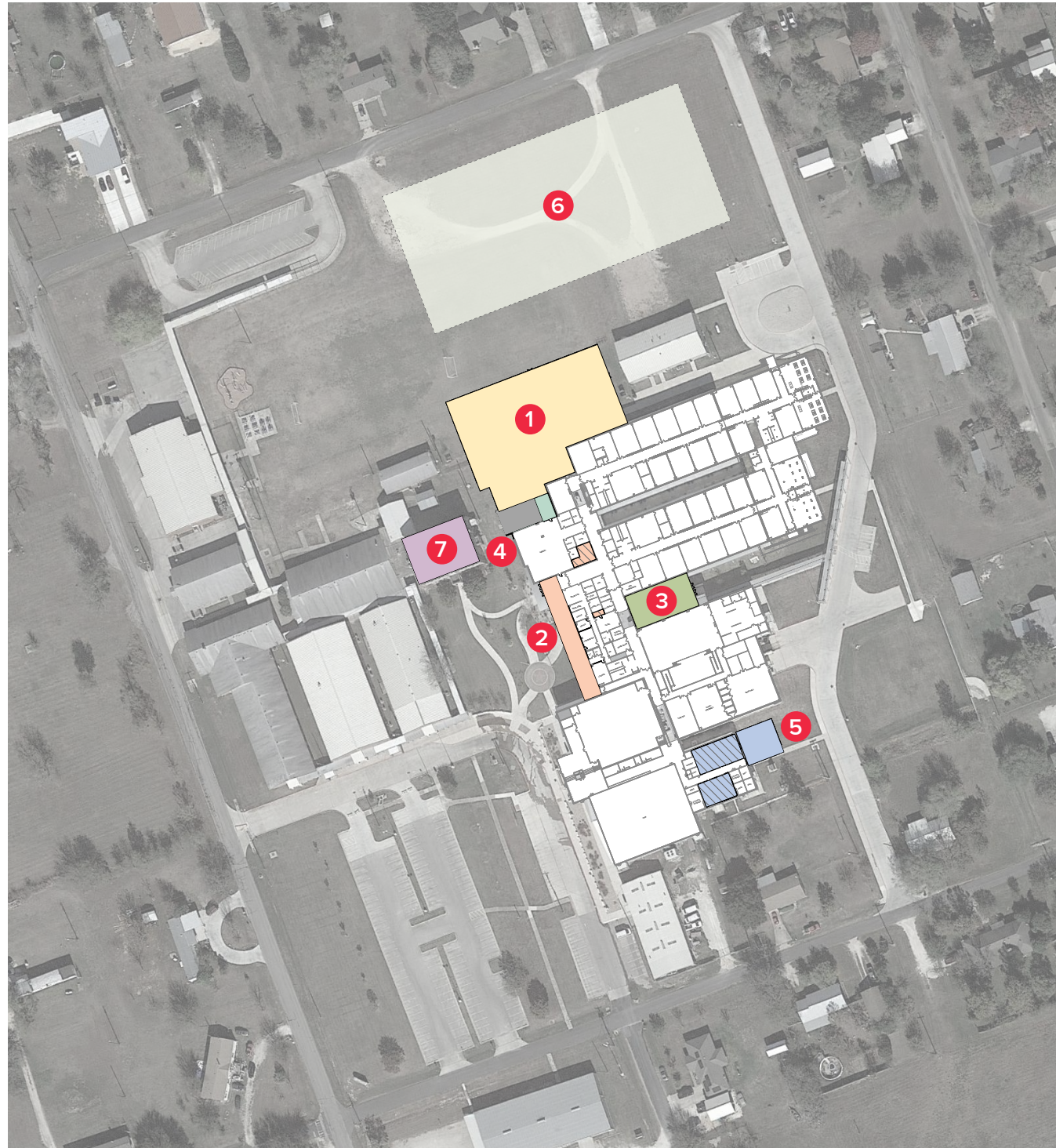

SITE PLAN KEY

- 1 Classroom Addition (1000 Student Capacity)
- 2 Administrative Expansion (Add Alternate)
- 3 Dining Expansion
- 4 Library Expansion
- 5 Additional Locker Rooms
- 6 Practice Field
- 7 1916 Building Renovation



JARRELL INDEPENDENT SCHOOL DISTRICT MIDDLE SCHOOL ADDITIONS & RENOVATIONS

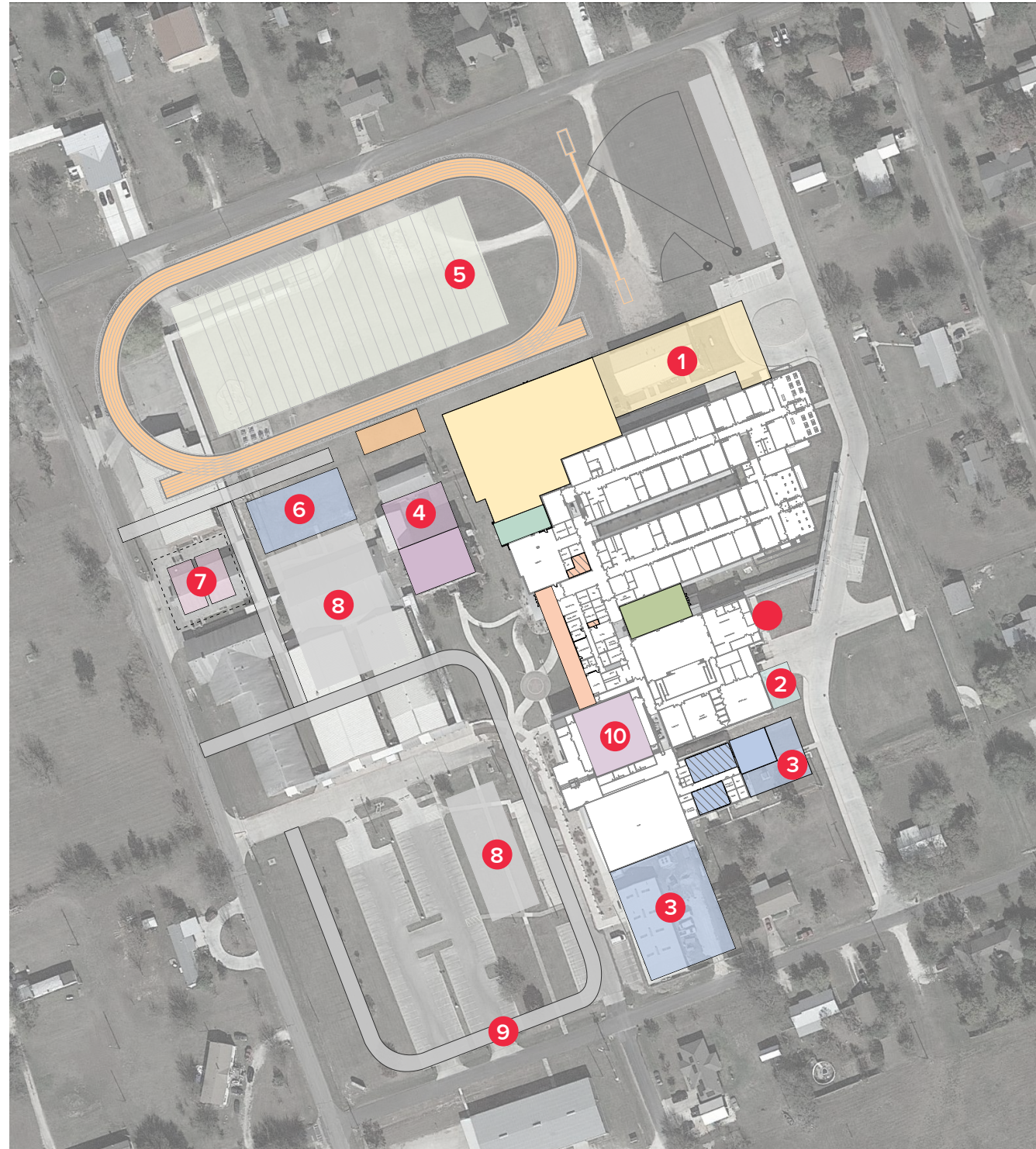

FUTURE CONSIDERATIONS SITE PLAN KEY

- 1 Classroom Addition (1200 Student Capacity)
- 2 Fine Arts Expansion
- 3 Athletics Expansion
- 4 Professional Learning Center Expansion
- 5 New Competition Track and Field
- 6 New Field House/Concessions
- 7 Tennis Courts
- 8 Additional Parking
- 9 New Pick-up / Drop-off Loop
- 10 Specialized Instruction

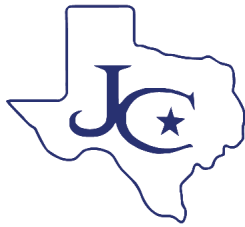

JARRELL INDEPENDENT SCHOOL DISTRICT MIDDLE SCHOOL ADDITIONS & RENOVATIONS

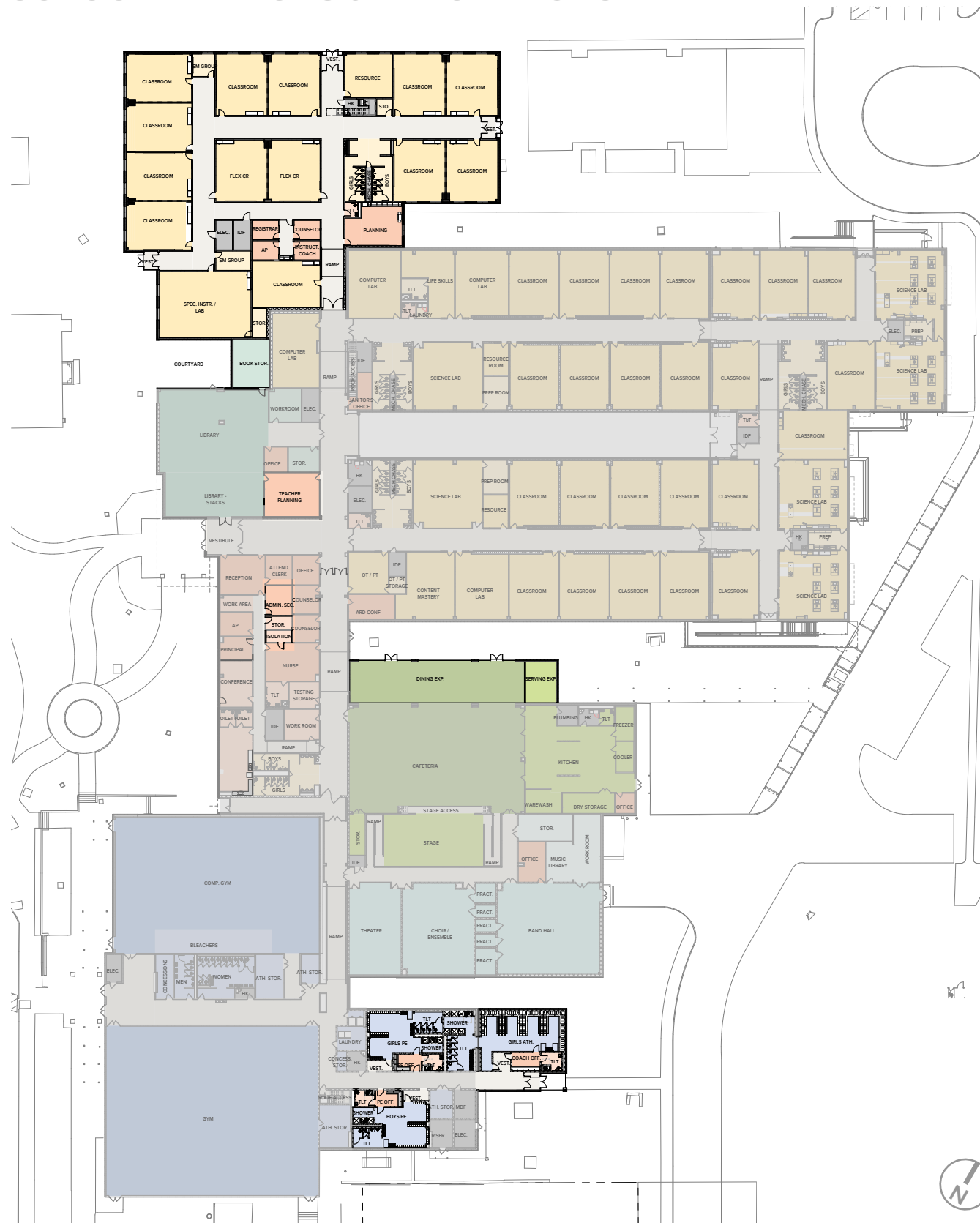

COLOR LEGEND

- Administration
- Administrative Support
- Academic
- Academic Support
- Library
- Library Support
- Dining
- Athletic
- Athletic Support
- Circulation
- Restrooms/Support Spaces

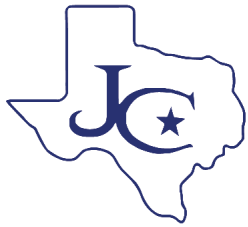

JARRELL INDEPENDENT SCHOOL DISTRICT
MIDDLE SCHOOL ADDITIONS & RENOVATIONS



COLOR LEGEND

- Administration
- Administrative Support
- Academic
- Academic Support
- Library
- Library Support
- Dining
- Athletic
- Athletic Support
- Circulation
- Restrooms/Support Spaces

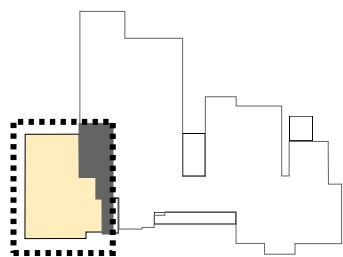

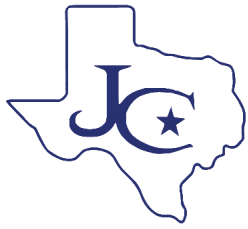

JARRELL INDEPENDENT SCHOOL DISTRICT MIDDLE SCHOOL ADDITIONS & RENOVATIONS

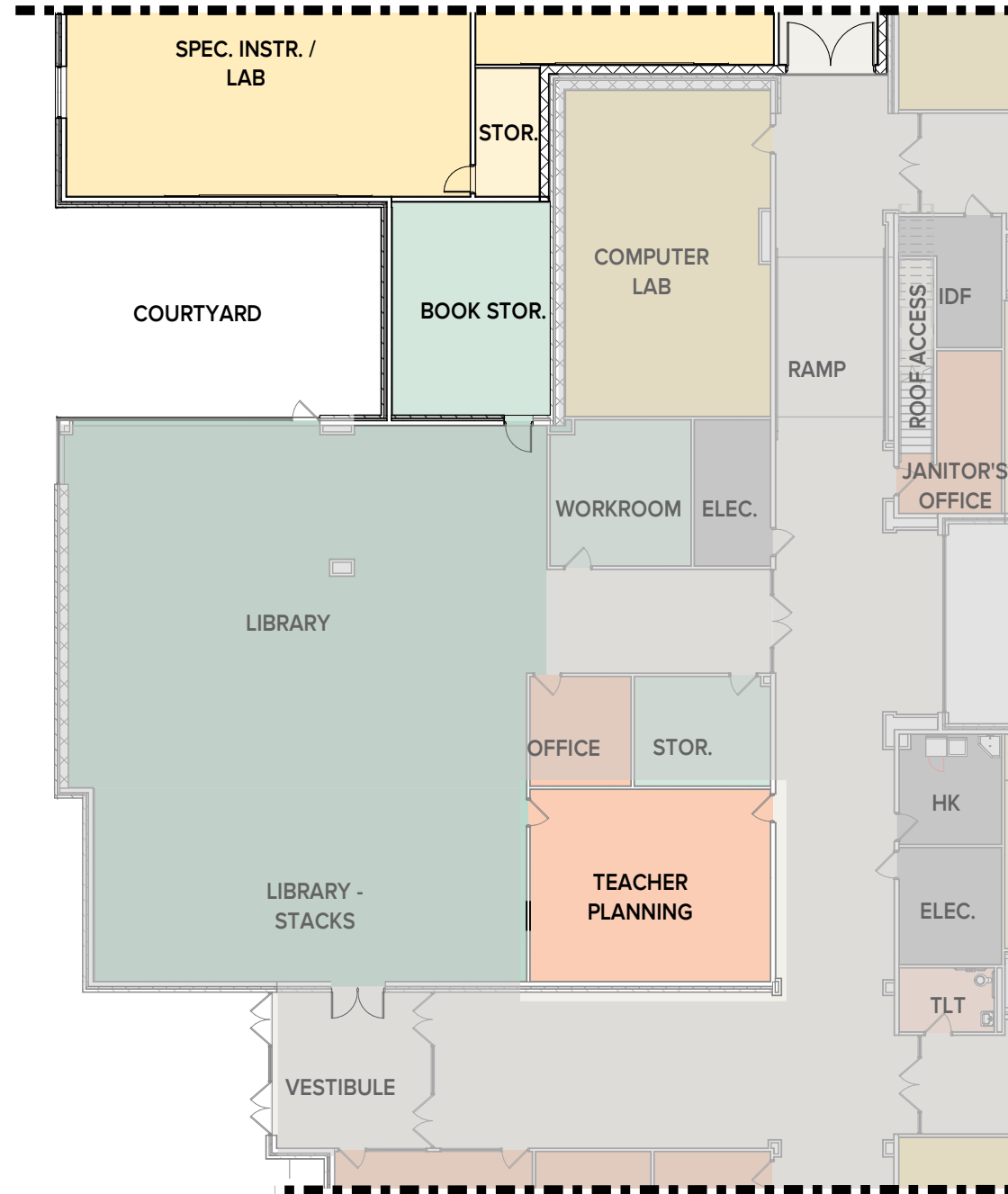

COLOR LEGEND

- Administration
- Administrative Support
- Academic
- Academic Support
- Library
- Library Support
- Dining
- Athletic
- Athletic Support
- Circulation
- Restrooms/Support Spaces

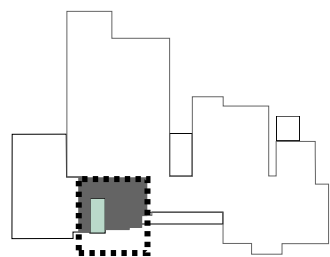

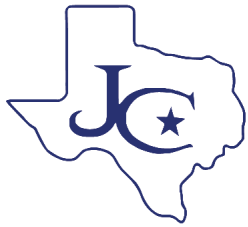

JARRELL INDEPENDENT SCHOOL DISTRICT MIDDLE SCHOOL ADDITIONS & RENOVATIONS



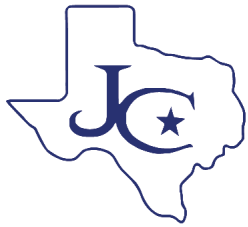

JARRELL INDEPENDENT SCHOOL DISTRICT MIDDLE SCHOOL ADDITIONS & RENOVATIONS



COLOR LEGEND

- Administration
- Administrative Support
- Academic
- Academic Support
- Library
- Library Support
- Dining
- Athletic
- Athletic Support
- Circulation
- Restrooms/Support Spaces

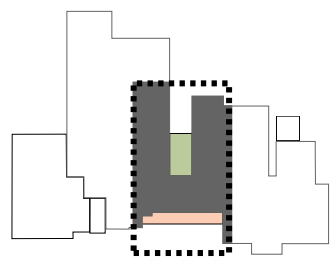

Huckabee

JARRELL INDEPENDENT SCHOOL DISTRICT
NOT FOR REGULATORY APPROVAL, PERMITTING OR CONSTRUCTION.
MICHAEL A. MOROW, TX REGISTRATION #25557, 12/15/2021

ALTERNATE - ADMIN. ADDITION

4.4a

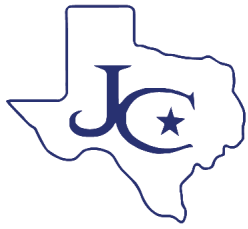

JARRELL INDEPENDENT SCHOOL DISTRICT
MIDDLE SCHOOL ADDITIONS & RENOVATIONS

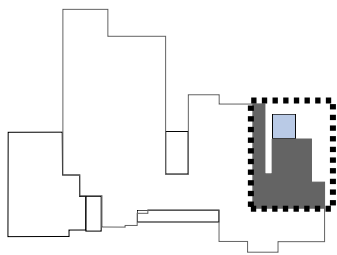
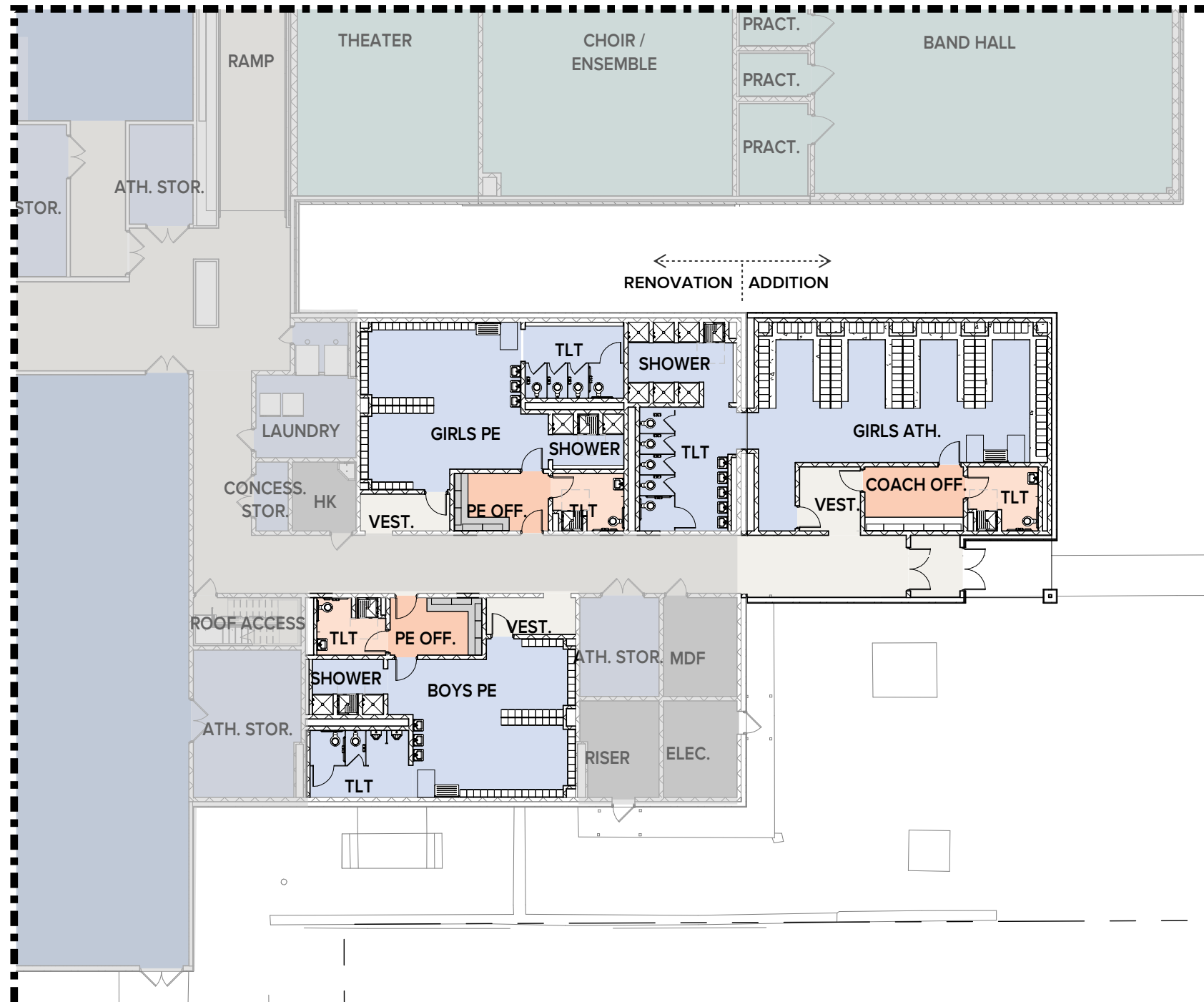

COLOR LEGEND

- Administration
- Administrative Support
- Academic
- Academic Support
- Library
- Library Support
- Dining
- Athletic
- Athletic Support
- Circulation
- Restrooms/Support Spaces

LOCKER COUNTS

- BOYS PE:**
275 LOCKERS (12X12X12 5 TIER)
- GIRLS PE:**
275 LOCKERS (12X12X12 5 TIER)
- GIRLS ATHLETICS:**
214 LOCKERS (12X18X36 2 TIER)
- BOYS ATHLETICS:**
EXISTING TO REMAIN AT NORTH BUILDING



JARRELL INDEPENDENT SCHOOL DISTRICT
MIDDLE SCHOOL ADDITIONS & RENOVATIONS



Huckabee

JARRELL INDEPENDENT SCHOOL DISTRICT
NOT FOR REGULATORY APPROVAL, PERMITTING OR CONSTRUCTION.
MICHAEL A. MOROW, TX REGISTRATION #25557, 12/15/2021

EXTERIOR RENDERING - CLASSROOM ADDITION

4.6

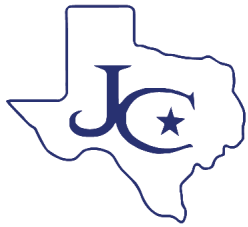

JARRELL INDEPENDENT SCHOOL DISTRICT
MIDDLE SCHOOL ADDITIONS & RENOVATIONS

Bond Construction Budget:\$10,828,000

Opinion of Probable Cost:\$10,298,109

(Beginning Construction May 2022)

Alternate #1: Operable Partitions+\$150,000

Alternate #2: Administration Addition+\$936,569

Alternate #3: Entry Canopy+\$150,000

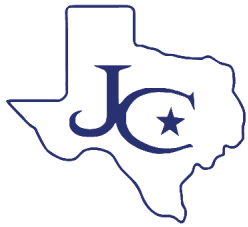

JARRELL INDEPENDENT SCHOOL DISTRICT MIDDLE SCHOOL ADDITIONS & RENOVATIONS

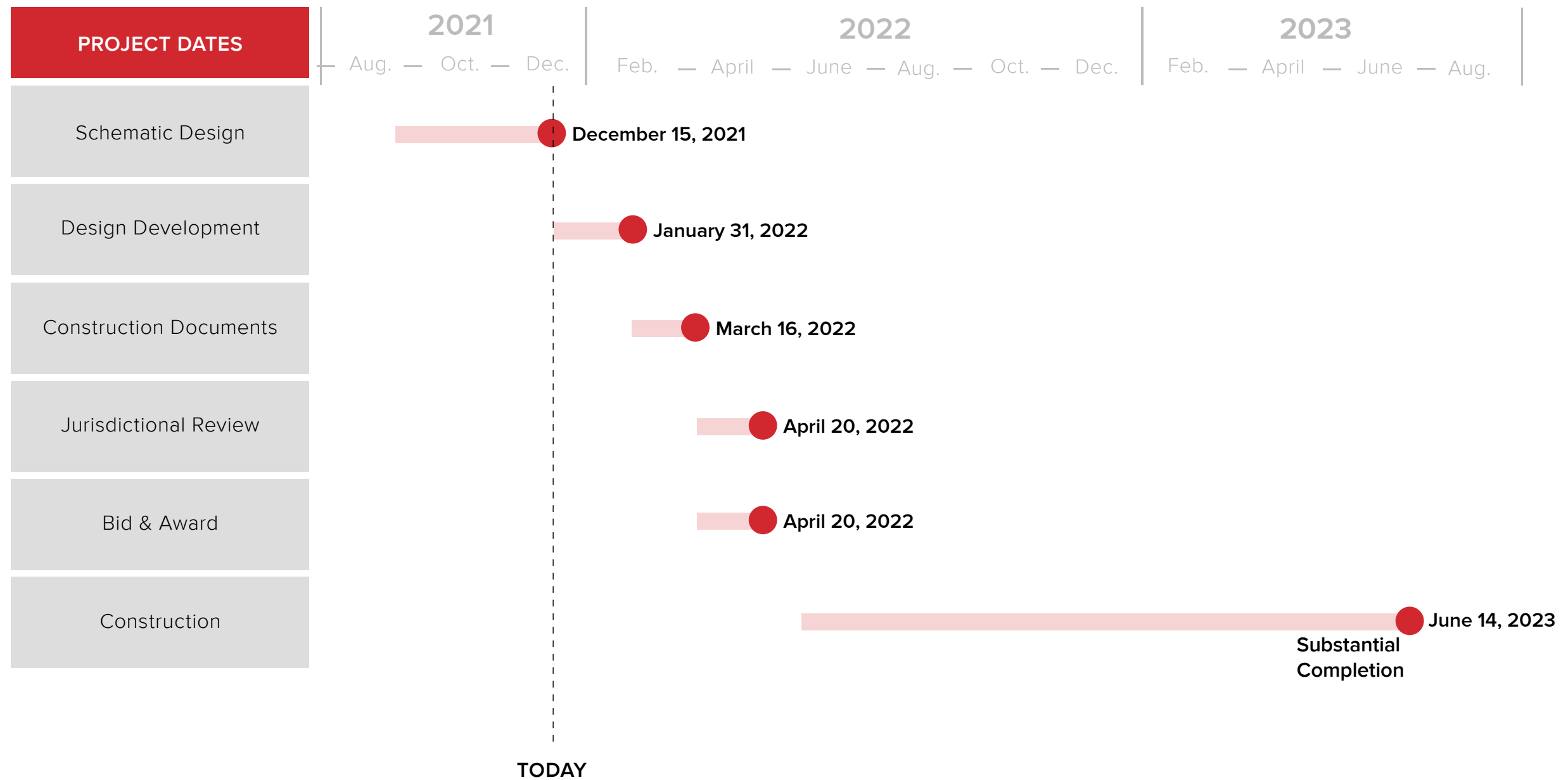

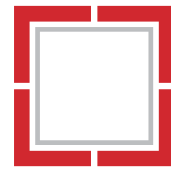

MORE THAN ARCHITECTS